

4308 Old Milford Mill Road  
Pikesville, MD 21208

# INDUSTRIAL PROPERTY AVAILABLE

## Rare Pikesville Industrial Building With Yard Space



### Property Highlights

- Available Space:** From 6,500 - 23,234 +/- SF  
7 Drive-thru at grade doors  
2,500 +/- SF office area.
- Lease Rate:** \$8.50 SF / NNN
- Lot Size:** 1.87 acres fully paved, fenced and lit
- Zoning:** ML
- Property Features:** 2,700 SF high bay truck repair bldg  
Warehouse 13' ft ceiling height  
Prime location with immediate -  
access to Reisterstown Road  
Close proximity to I-695 Beltway

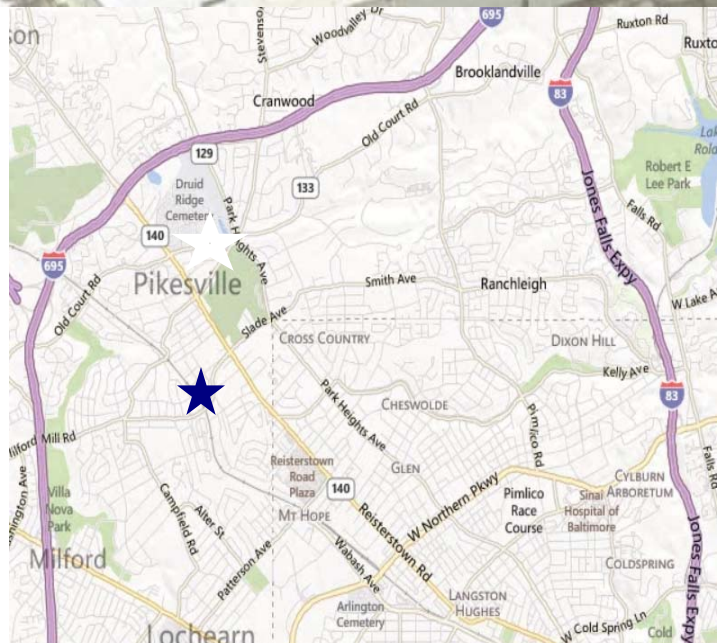

FOR MORE INFORMATION  
PLEASE CONTACT AGENT:

**MORDY ITZKOWITZ**  
443-838-1438

Mordy@oxfordra.net



**OXFORD** | Realty Advisors

9510 Persimmon Tree Rd \* Suite 105 \* Potomac, MD 20854 \* 301.983.8000 \* 301.983.0444 (fax)

Although information contained herein is from sources deemed reliable, such information has not been verified and is submitted to errors, omissions, change of price, withdrawal or further change without notice. We include projections, opinion, assumptions or estimates for example only, and they may not represent current or future performance of the property. You, along with your tax and legal advisors, should conduct your own investigation of the property and transaction.

4308 Old Milford Mill Road  
Pikesville, MD 21208

# INDUSTRIAL PROPERTY AVAILABLE

Floor Plan

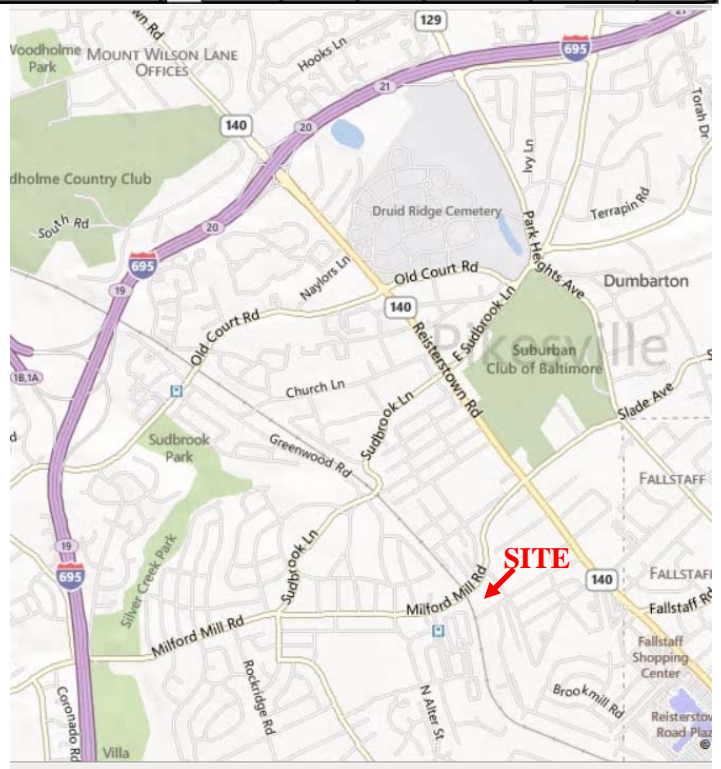
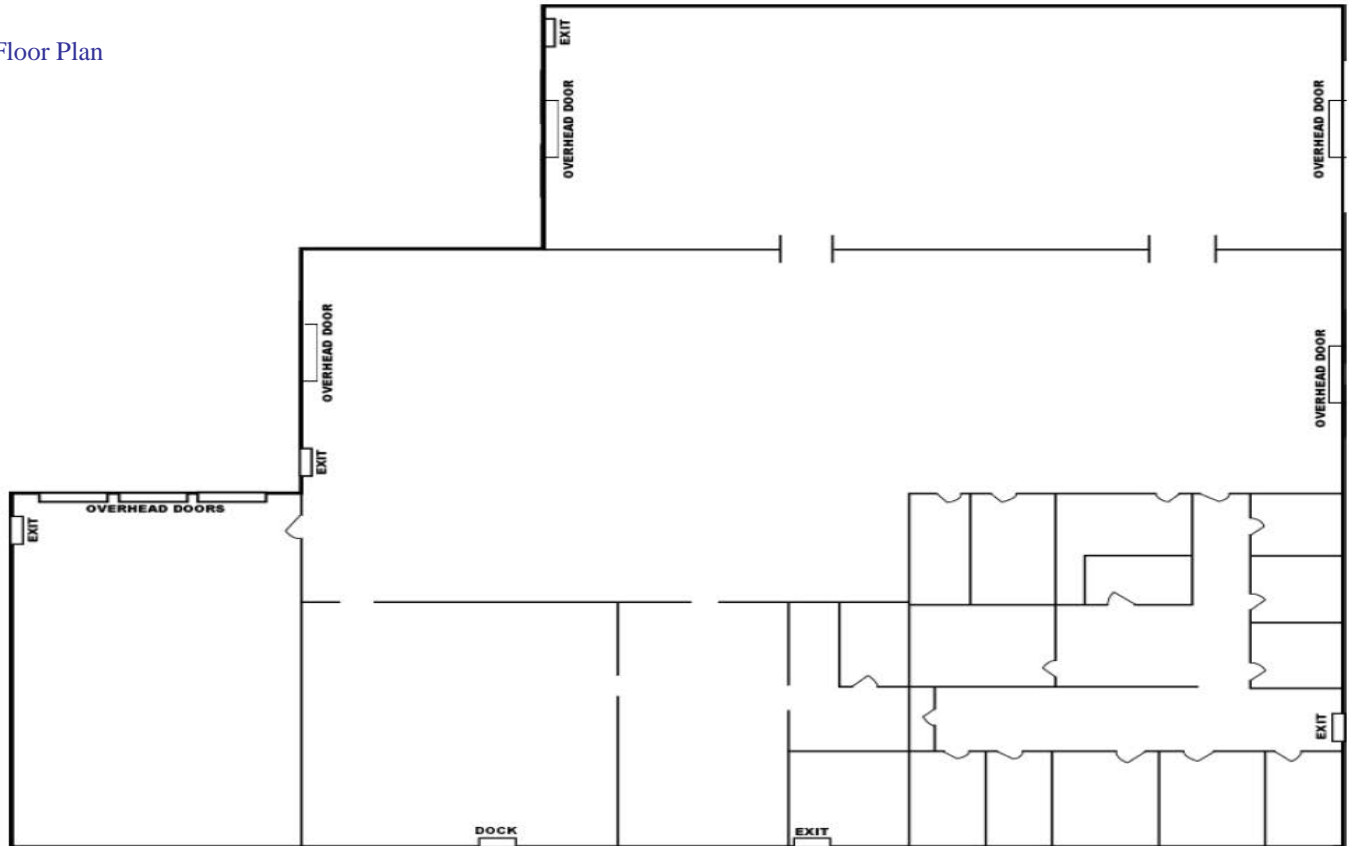

FOR MORE INFORMATION  
PLEASE CONTACT AGENT:  
**MORDY ITZKOWITZ**  
443-838-1438  
Mordy@oxfordra.net

